

- Type:** Single Ended Beam
- Material:** Stainless Steel
- Protection:** IP 68
- Features:** Low Profile  
Nice Exterior
- Application:** Belt Weighing  
Hostile Environments  
Loss In Weight Feeders  
Marine Scales  
Food Industries



**Specifications:**

<b>Capacity</b>	kg	10 / 50 / 100 / 200 / 300 / 500 / 1000
<b>Accuracy Class</b>		<b>C3</b>
<b>Max. Number of Verification Intervals</b>	$n_{max}$	3000
<b>Minimum Load cell Verification Interval</b>	$V_{min}$	$E_{max}/5000$
<b>Temperature Effect on Zero</b>	%FS/10°C	$\leq \pm 0.020$
<b>Temperature Effect on Sensitivity</b>	%FS/10°C	$\leq \pm 0.020$
<b>Combined Error</b>	%FS	$\leq \pm 0.020$
<b>Creep</b>	%FS	$\leq \pm 0.020$
<b>Output Sensitivity</b>	mv/v	$2.0 \pm 0.010$
<b>Input Resistance</b>	$\Omega$	$385 \pm 10$
<b>Output Resistance</b>	$\Omega$	$350 \pm 3.5$
<b>Insulation Resistance</b>	M $\Omega$	$\geq 5000$
<b>Zero Balance</b>	%FS	1.0
<b>Temperature, Compensated</b>	°C	-10 ~ +50
<b>Temperature, Operating</b>	°C	-20 ~ +60
<b>Excitation, Recommended</b>	v	5 ~ 12(DC)
<b>Safe Overload</b>	%FS	120
<b>Ultimate Overload</b>	%FS	200
<b>Standard Cable Length</b>	m	5

**Dimensions:**

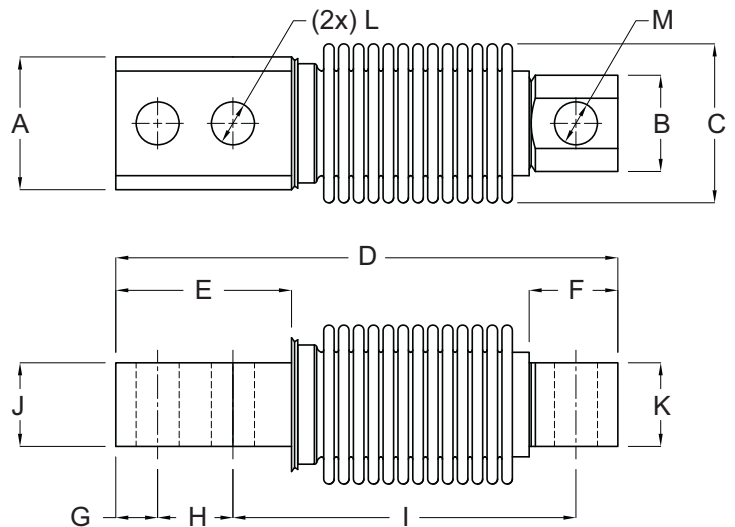
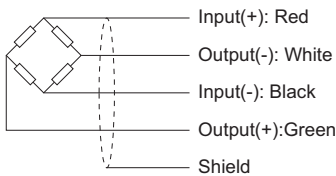

CAP.	A	B	C	D	E	F	G	H	I	J	K	L	M
10,50,100,200	35	26	45	123	45	19	13	18	82	22	20	8.5	8.5
300,500,1000	50	36	60	210	93	53	15	40	133	34	25	13	14

All dimensions: mm.